

WETRO

INSTALLATION INSTRUCTIONS | JUNE 2024

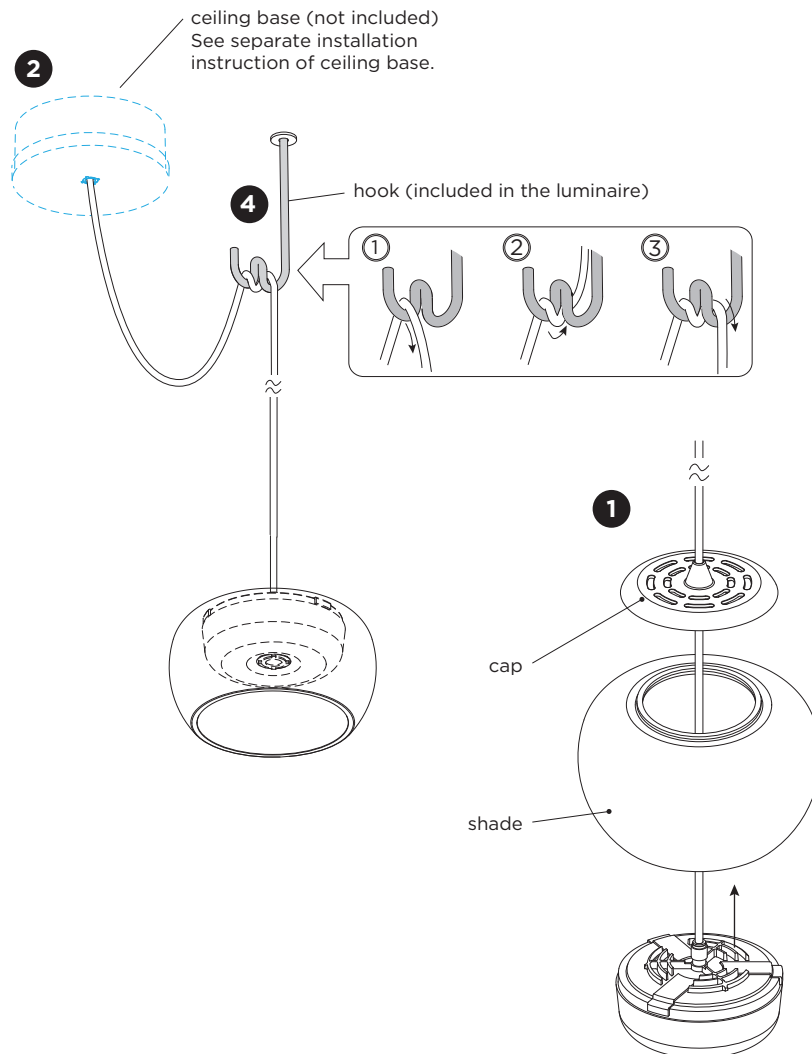

DIMENSIONS

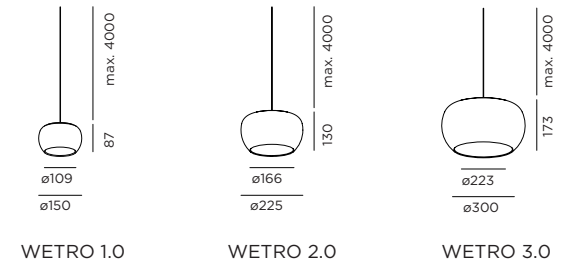

MOUNTING INSTRUCTION

- 1 Pass the cable of the LED module through the glass shade and the cap.
- 2 **POWER CONNECTION**
Connect to 220-240V.
Connect the wires in the ceiling base (see separate instructions manual from the ceiling base).



- 3 Tighten the cap after balancing the glass in a straight way by screwing it on the LED module.
- 4 Optionally use the hook to support the cable.

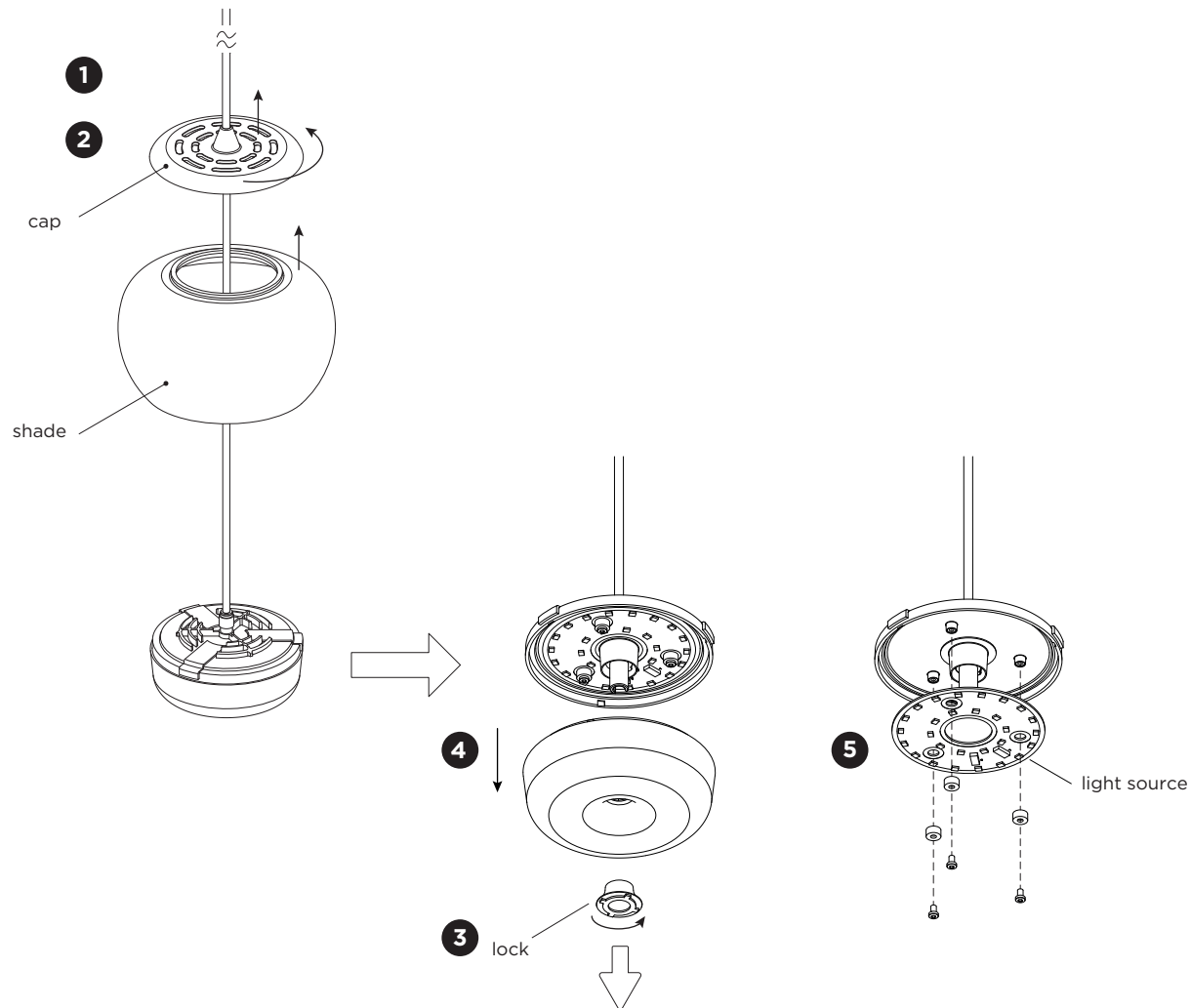

DISMOUNTING AND RECYCLING INSTRUCTIONS

Light source

- 1 Loosen the wires from the power connection (see separate instructions manual from the ceiling base).
- 2 Turn the cap counter clockwise. Remove the cap and the shade from the fixture.
- 3 Remove the lock by turning it counter clockwise.
- 4 Remove the cover.
- 5 Loosen the screws and wires to remove the light source.

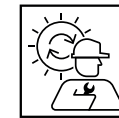

The light source is replaceable by Wever & Ducreé or by a professional with explicit authorisation. For more information please contact your local Wever & Ducreé customer service point.



This luminaire contains a light source with the energy class G.