

# ROOMOR WALL 1.0 / 2.0

05-Sep.-2018

## ROOMOR WALL 1.0 PAR16

max. 35W | GU10 | 100-240VAC | 50-60Hz  
 CE IP20 45°/45°

### BODY COLOUR

<span style="display:inline-block; width:10px; height:10px; background-color:red; border:1px solid black;"></span> red texture	338120R_
<span style="display:inline-block; width:10px; height:10px; background-color:grey; border:1px solid black;"></span> grey texture	338120G_
<span style="display:inline-block; width:10px; height:10px; background-color:black; border:1px solid black;"></span> black texture	338120B_

### OPTIONAL

No shade	00
<b>SHADE 1.0</b>	
<span style="display:inline-block; width:10px; height:10px; background-color:black; border:1px solid black;"></span> black texture	B1
<span style="display:inline-block; width:10px; height:10px; background-color:red; border:1px solid black;"></span> red texture + white	R1
<span style="display:inline-block; width:10px; height:10px; background-color:grey; border:1px solid black;"></span> grey texture + white	G1
<span style="display:inline-block; width:10px; height:10px; background-color:black; border:1px solid black;"></span> black texture + gold	K1
<span style="display:inline-block; width:10px; height:10px; background-color:grey; border:1px solid black;"></span> felt grey (max.15W)	F1

for PAR16 lamps see our catalogue

## ROOMOR WALL 2.0 PAR16

max. 35W | GU10 | 100-240VAC | 50-60Hz  
 CE IP20 45°/45°

### BODY COLOUR

<span style="display:inline-block; width:10px; height:10px; background-color:black; border:1px solid black;"></span> black texture	338220B_
--	----------

### OPTIONAL

No shade	00
<b>SHADE 1.0</b>	
<span style="display:inline-block; width:10px; height:10px; background-color:black; border:1px solid black;"></span> black texture	B1
<span style="display:inline-block; width:10px; height:10px; background-color:black; border:1px solid black;"></span> black texture + gold	K1
<span style="display:inline-block; width:10px; height:10px; background-color:grey; border:1px solid black;"></span> felt grey (max.15W)	F1
<b>SHADE 2.0</b>	
<span style="display:inline-block; width:10px; height:10px; background-color:black; border:1px solid black;"></span> black texture	B2
<span style="display:inline-block; width:10px; height:10px; background-color:black; border:1px solid black;"></span> black texture + gold	K2
<span style="display:inline-block; width:10px; height:10px; background-color:grey; border:1px solid black;"></span> felt grey (max.15W)	F2

for PAR16 lamps see our catalogue

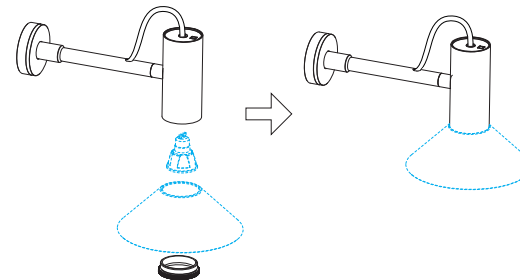
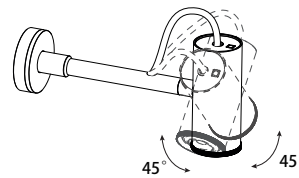
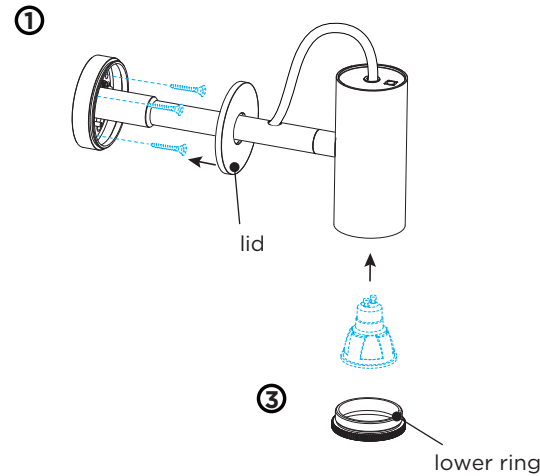
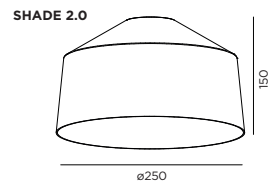
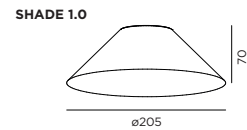

## DIMENSIONS

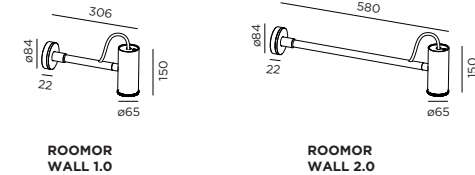

## MOUNTING INSTRUCTION

① Open the lid, and mount the base on the wall.  
**(Ensure solid fixation on the wall.)**  
 and then close the lid by pressing.

## ② POWER CONNECTION

Connect the wires  
 connection: STANDARD version

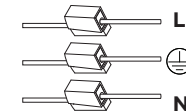

③ Unscrew the lower ring of the luminaire body, install a bulb (bulb is not included), and then screw the lower ring back.

