

DIMENSIONS

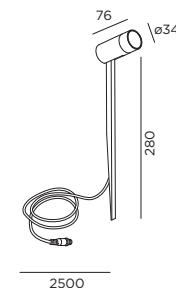

MOUNTING INSTRUCTION

- 1 Get sure the cable is in the slot on the backside of the spike.
- 2 **POWER CONNECTION**
Connect to plug & play driver with a straight connector or T-connector.
For detailed information to the plug & play system see next page.
- 3 Put the fixture in the soil.

Do not cut off the connector.
This will cancel the warranty.

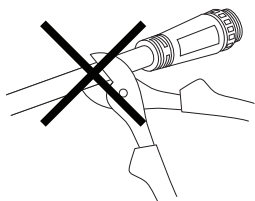

Place the cables deep enough in the ground or protect them with a cover/tube to avoid damage due to a shovel.

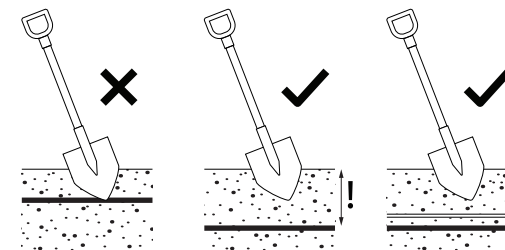

PLUG & PLAY SYSTEM

luminaire power	max. cable length in relation to distance to first luminaire								max. cable length
	≤1,0m	≤2,5m	≤5,0m	≤7,5m	≤10,0m	≤15,0m	≤20,0m	≤30,0m	
15W	50m	50m	50m	50m	50m	50m	50m	50m	
30W	50m	50m	50m	50m	50m	50m	36m	6m	
45W	50m	50m	50m	42m	34m	20m	4m	-	
60W	44m	40m	32m	26m	18m	2m	-	-	

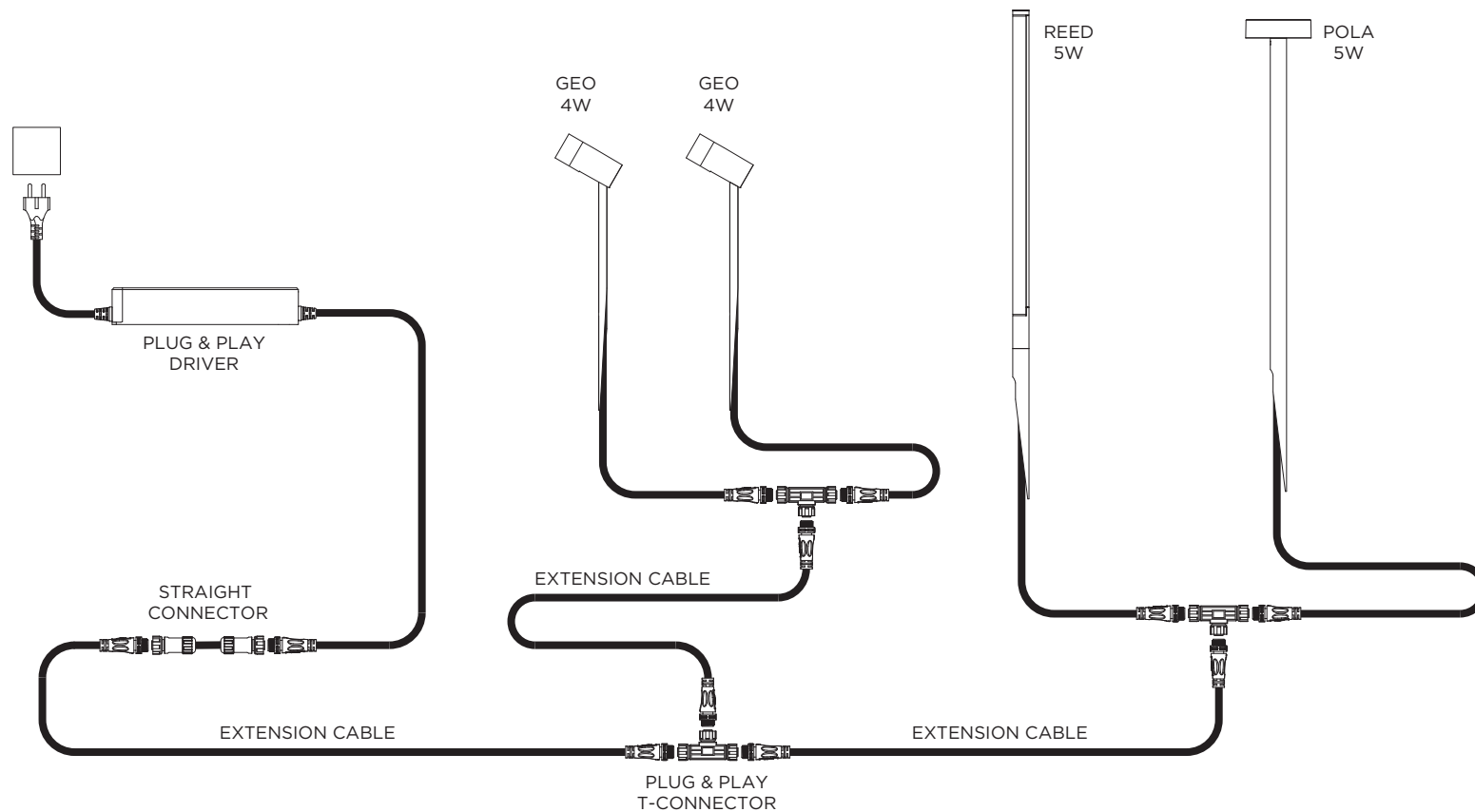

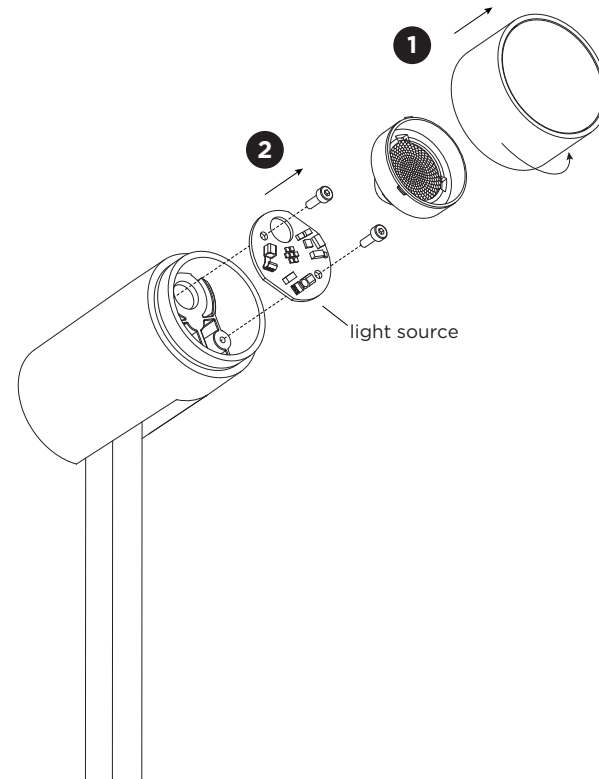

DISMOUNTING AND RECYCLING INSTRUCTIONS

Light source

- 1 Unscrew the cover and remove the lens.
- 2 Loosen the wires and remove the light source by unscrewing it.

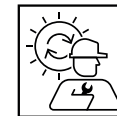

The light source is replaceable by Wever & Ducré or by a professional with explicit authorisation. For more information please contact your local Wever & Ducré customer service point.



This luminaire contains a light source with the energy class G.